

Technical data/ Type	MK100	MK130	MB2000C	MB2300	MB2700	MP3300	MP4300	MP5300
Max. Output Torque (Nm)	10000	24000	30000	36000	39000	48000	60000	70000
Ratios i=	26	29.4	131	103	103	133.7	135.3	135.3
Max. input Speed (rpm)	600	800	2000	2500	2500	2500	2500	2500
Drum Capacity (m³)	1 - 1.5	2.5 - 3.5	4 - 5	5 - 6	6 - 7	7 - 8	8 - 10	10 -14
Oil Quantity ( lt ±10%)	1.5	4	4.5	7	7	7.5	14	14
Dry Weight (kg)	60	125	142	160	180	190	330	335
Hydraulic Motor	Provided by user							
Use oil according to following normes:	SAE 85W90/ API GL4 GL5							

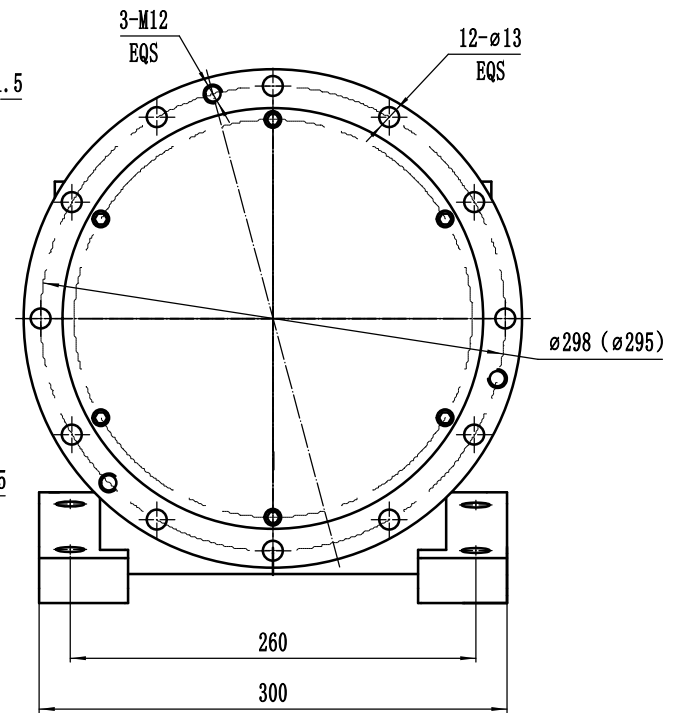

View A

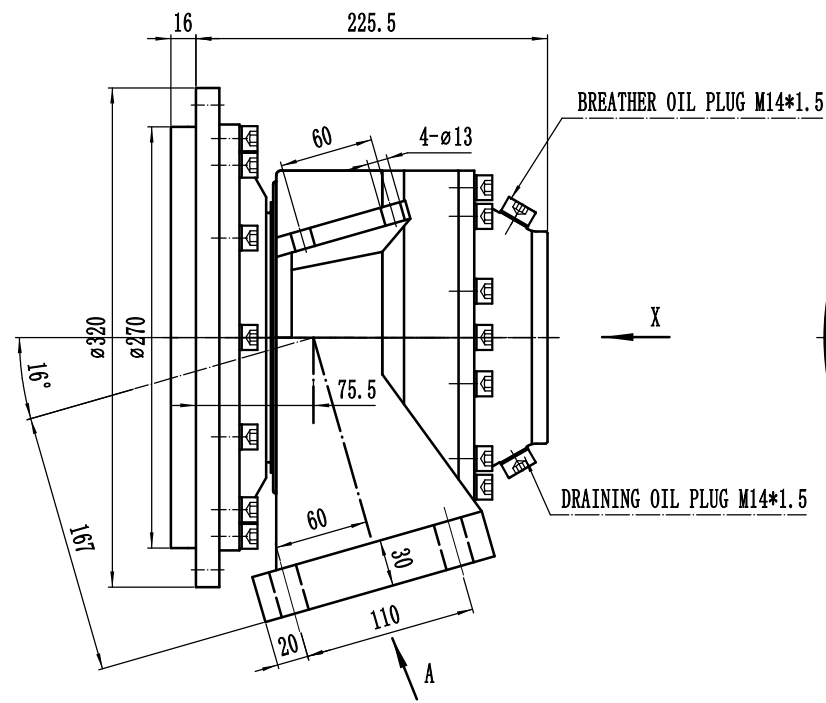
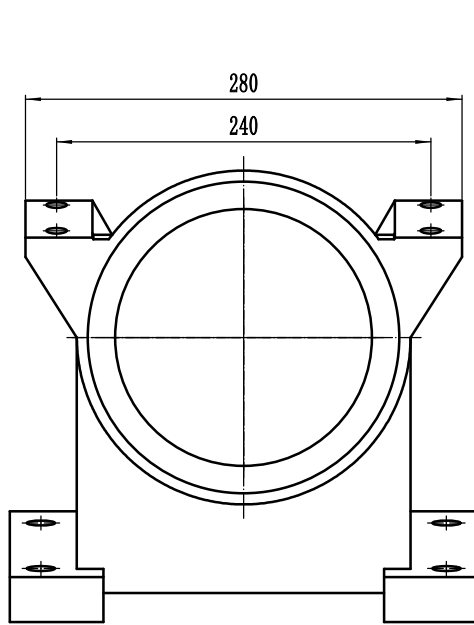
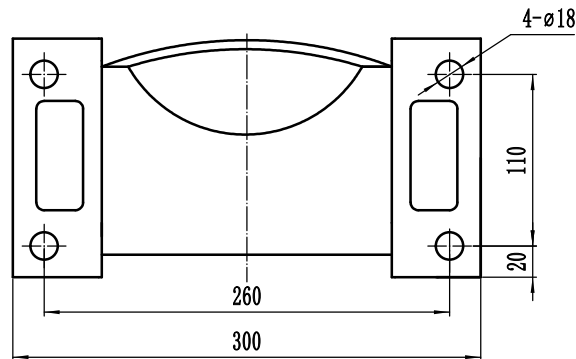

View X

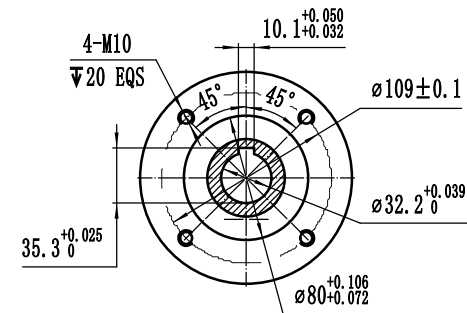

#### Gearbox Technical Data

Code number	MK100
Drum Capacity	1 - 1.5 m <sup>3</sup>
Max. Output Torque	10000 Nm
Ratios (i)	1 : 26
Max. input Speed	600 rpm
Use oil according to following normes: SAE 85W90/ API GL4 GL5	
Oil Quantity	1.5 lt ±10%
Dry Weight	60 kg
Hydraulic Motor	Provided by user

		Maxma Fluid Power Inc.	
Gearbox For Truck Mixer			
Code Number	MK100	Ratio	1:2.5

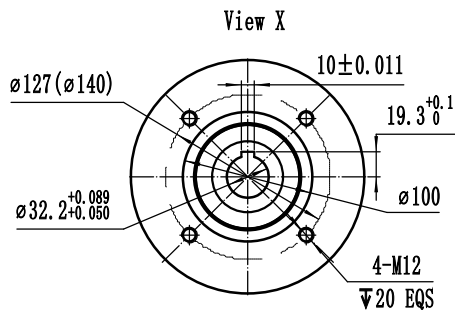
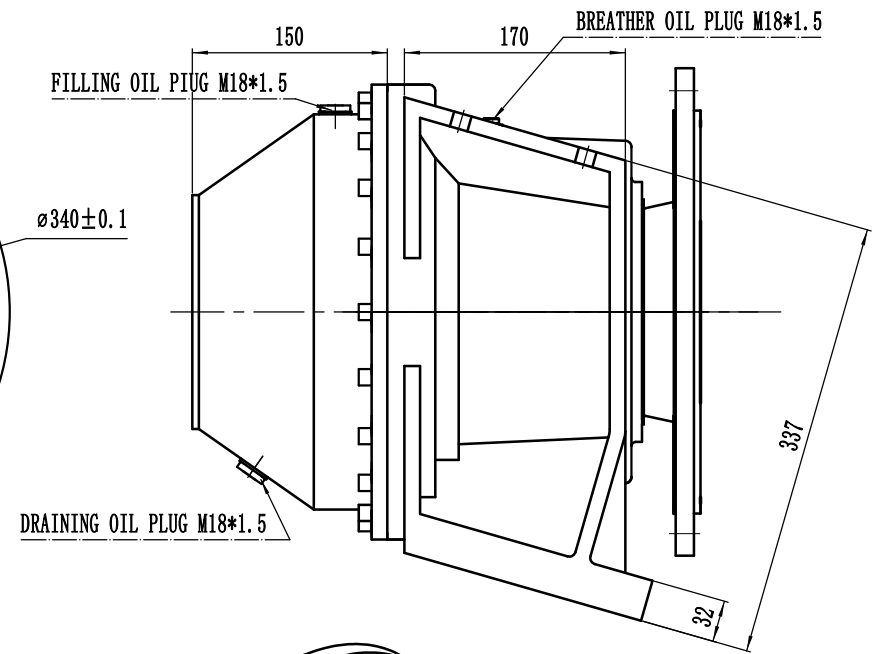
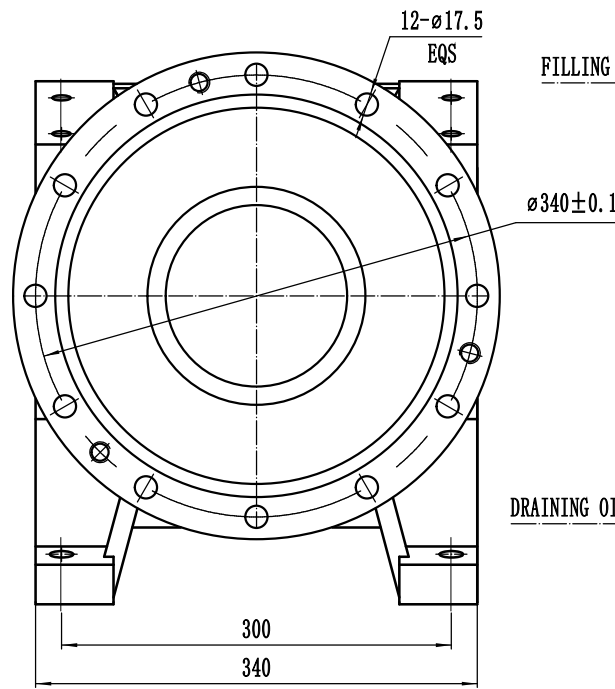
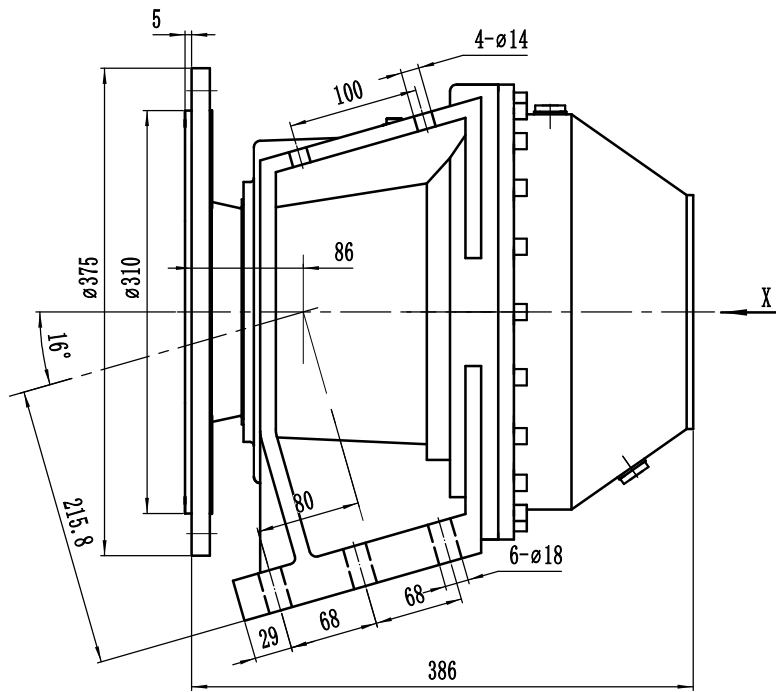

MOTOR ADAPTOR DETAIL

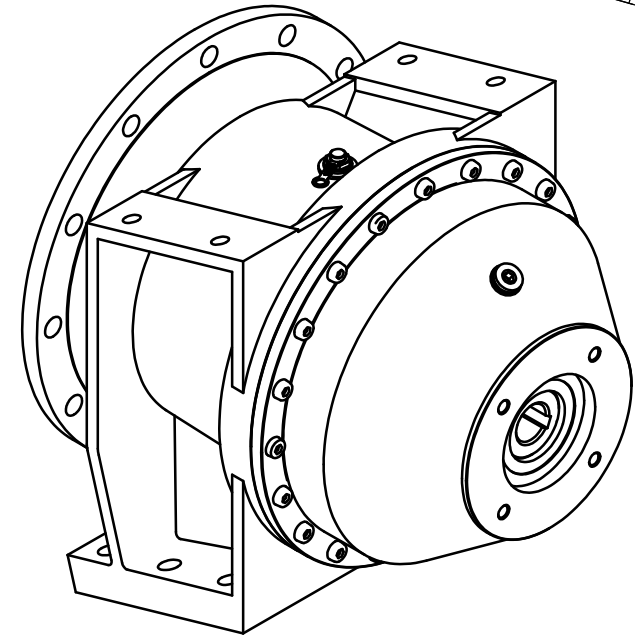
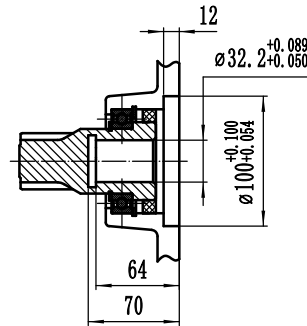

Gearbox Technical Data

Code number	MK130
Drum Capacity	2.5 - 3.5 m <sup>3</sup>
Max. Output Torque	24000 Nm
Ratios (i)	1 : 29.4~35
Max. input Speed	800 rpm
Use oil according to following normes: SAE 85W90/ API GL4 GL5	
Oil Quantity	4 lt ±10%
Dry Weight	125 kg
Hydraulic Motor	Provided by user

		Maxma Fluid Power Inc.	
Gearbox For Truck Mixer			
Code Number	MK130	Ratio	1:3

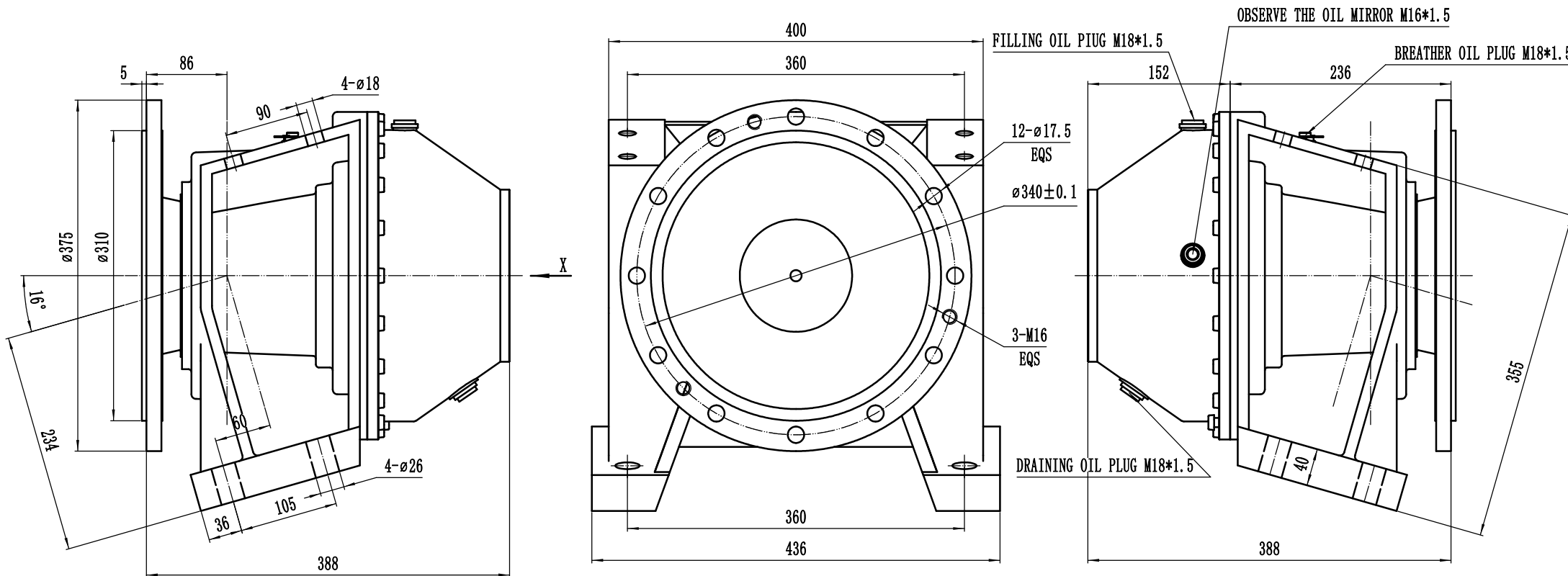

View X

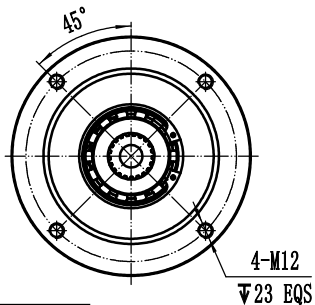

MOTOR ADAPTOR DETAIL

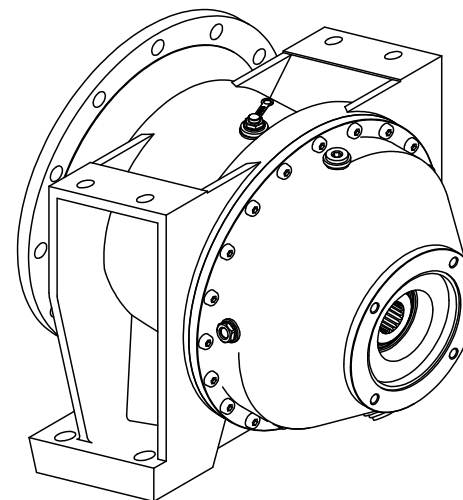
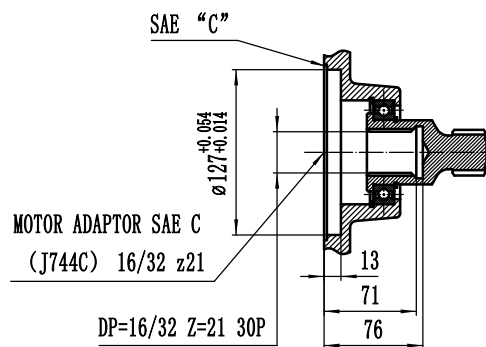

Gearbox Technical Data

Code number	MB2000C
Drum Capacity	4 - 5 m <sup>3</sup>
Max. Output Torque	30000 Nm
Ratios (i)	1 : 131
Max. input Speed	2000 rpm
Use oil according to following normes: SAE 85W90/ API GL4 GL5	
Oil Quantity	4.5 lt $\pm 10\%$
Dry Weight	142 kg
Hydraulic Motor	Provided by user

		Maxma Fluid Power Inc.	
Gearbox For Truck Mixer			
Code Number	MB2000C	Ratio	1:3

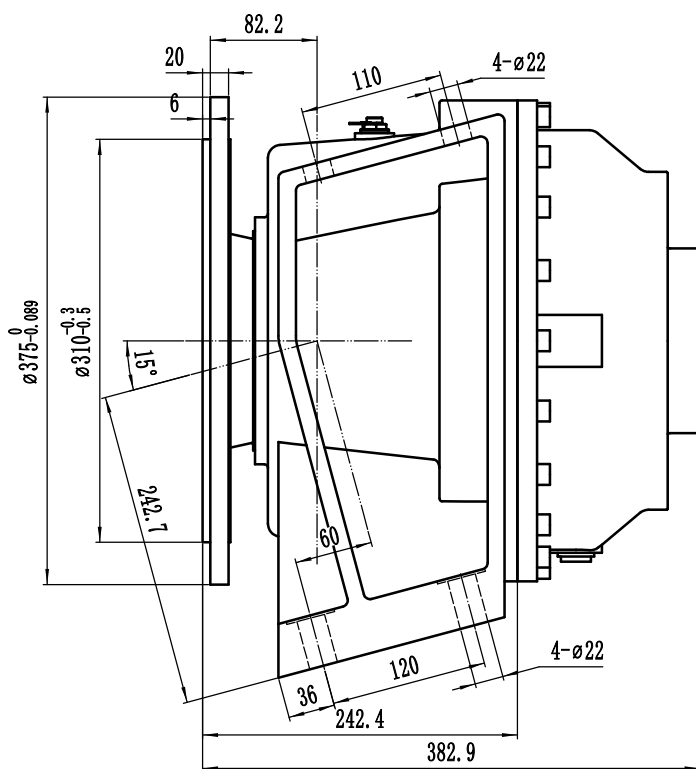

X

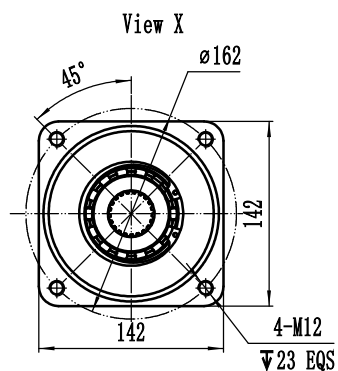
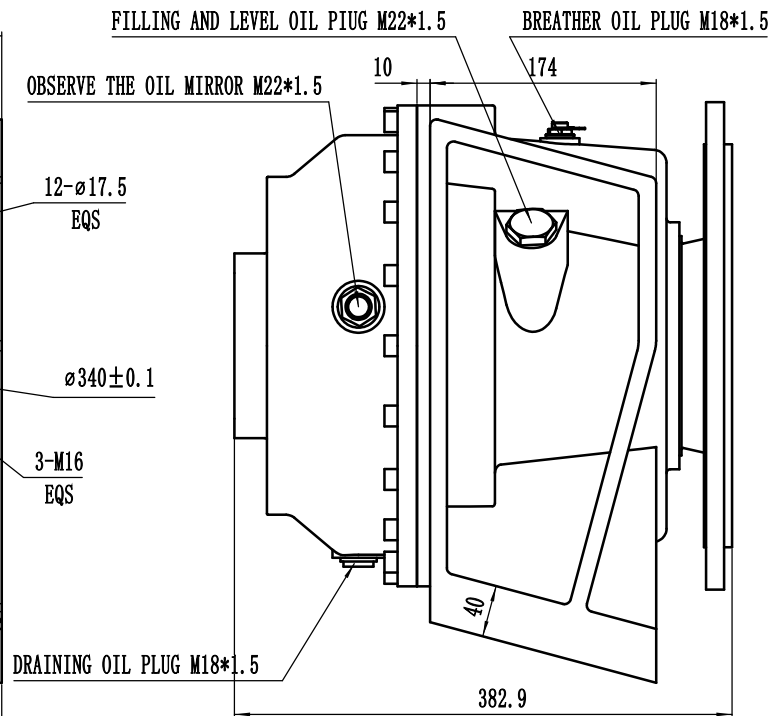
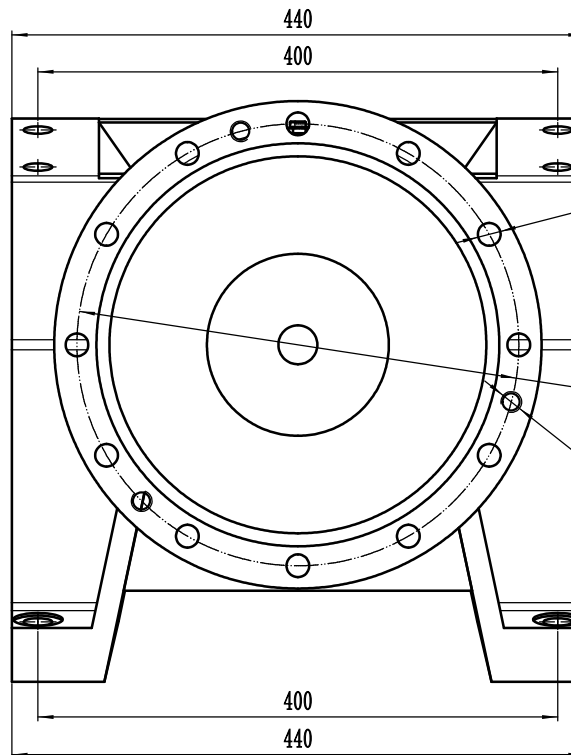

### MOTOR ADAPTOR DETAIL

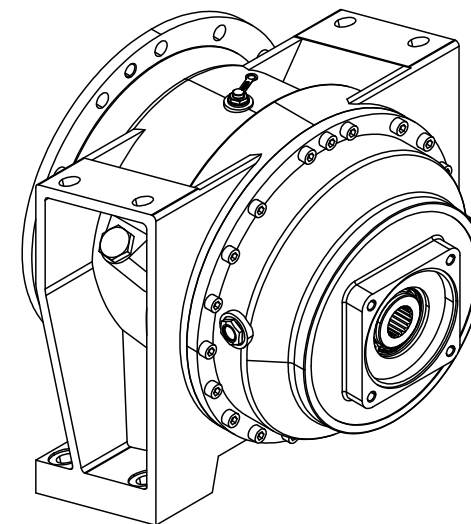
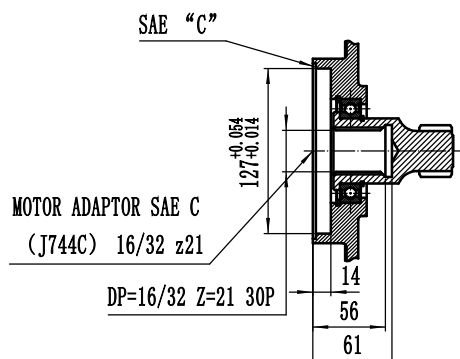

### Gearbox Technical Data

Code number	MB2300
Drum Capacity	5 - 6 m <sup>3</sup>
Max. Output Torque	36000 Nm
Ratios (i)	1 : 103~131
Max. input Speed	2500 rpm
Use oil according to following normes: SAE 85W90/ API GL4 GL5	
Oil Quantity	7 lt ±10%
Dry Weight	160 kg
Hydraulic Motor	Provided by user

		Maxma Fluid Power Inc.	
Gearbox For Truck Mixer			
Code Number	MB2300	Ratio	1:3

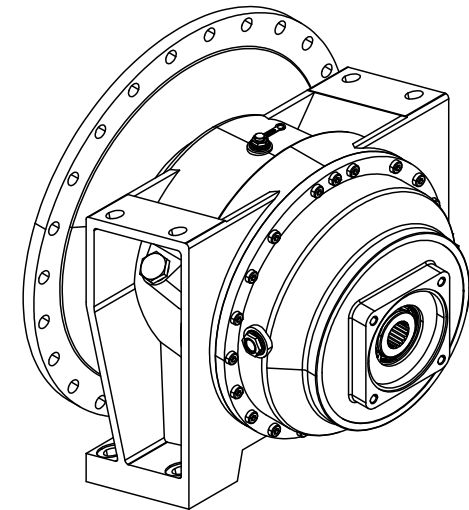
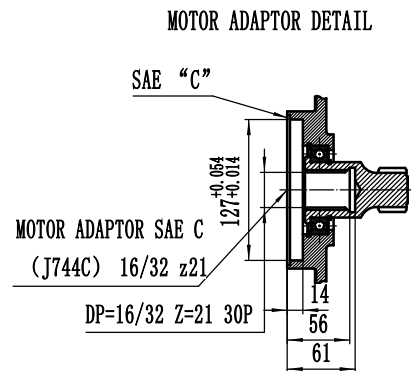
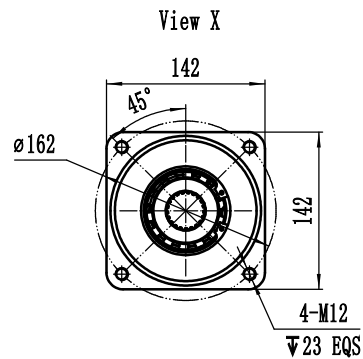
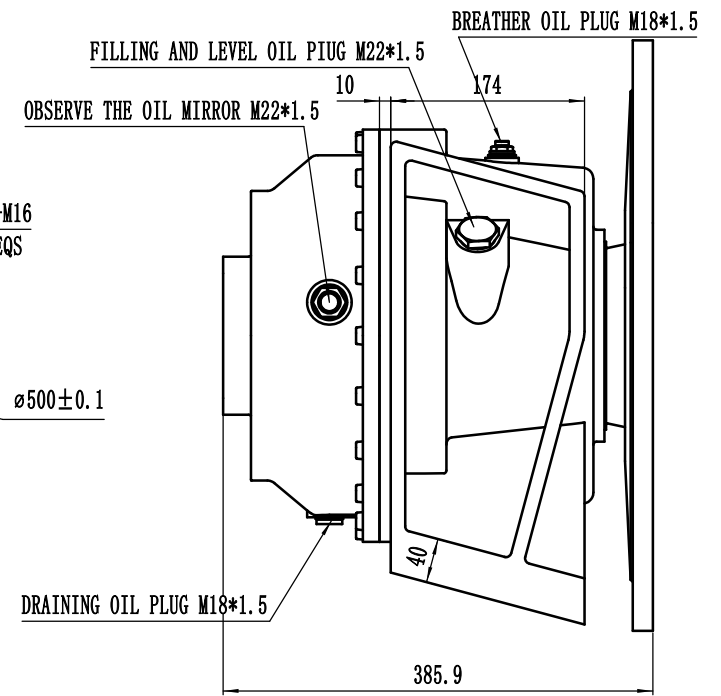
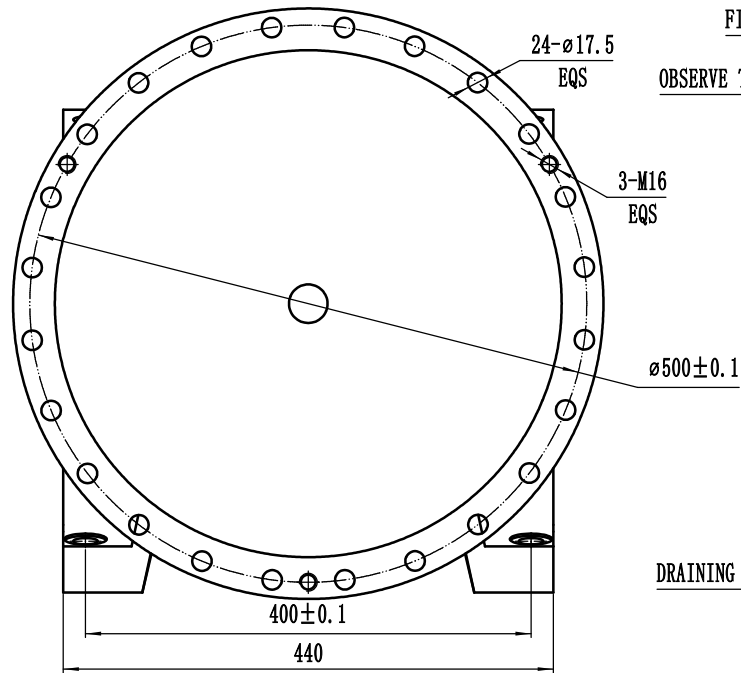
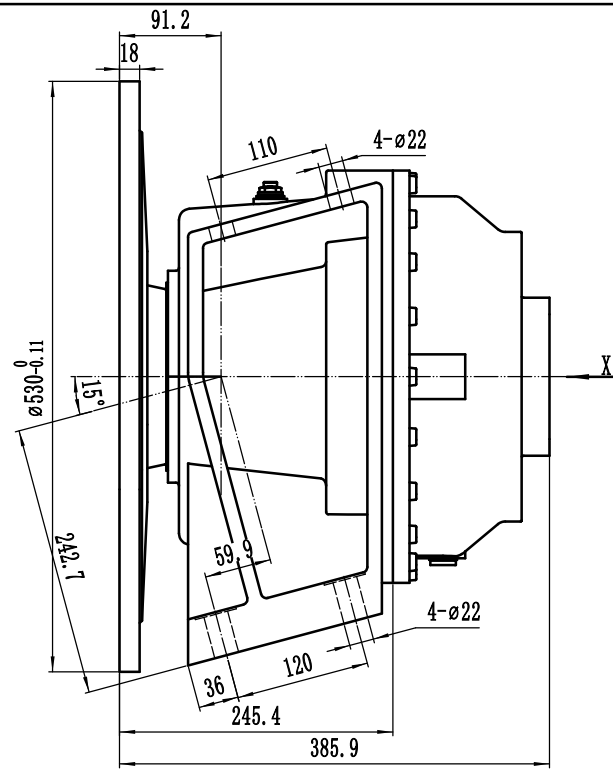

#### Gearbox Technical Data

Code number	MB2700
Drum Capacity	6 - 7 m <sup>3</sup>
Max. Output Torque	39000 Nm
Ratios (i)	1 : 103~131
Max. input Speed	2500 rpm
Use oil according to following normes: SAE 85W90/ API GL4 GL5	
Oil Quantity	7 lt ±10%
Dry Weight	180 kg
Hydraulic Motor	Provided by user

		Maxma Fluid Power Inc.	
Gearbox For Truck Mixer			
Code Number	MB2700	Ratio	1:3.5

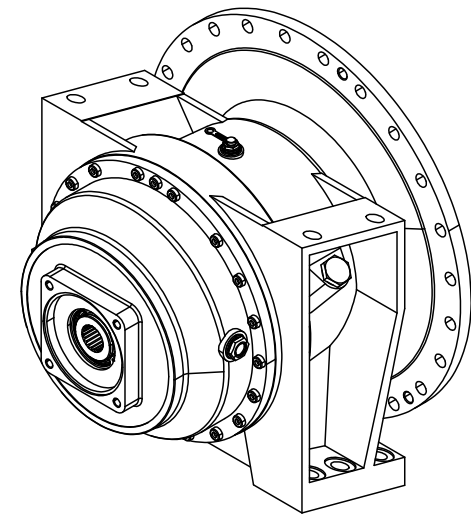
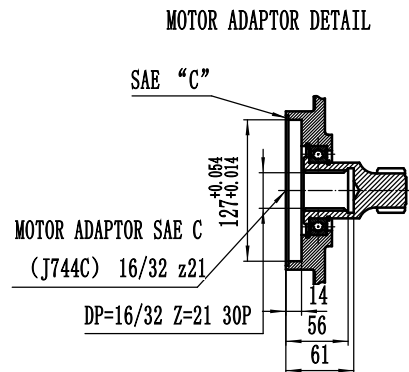
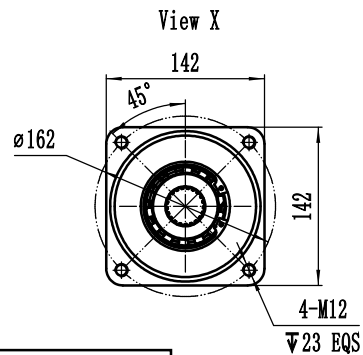
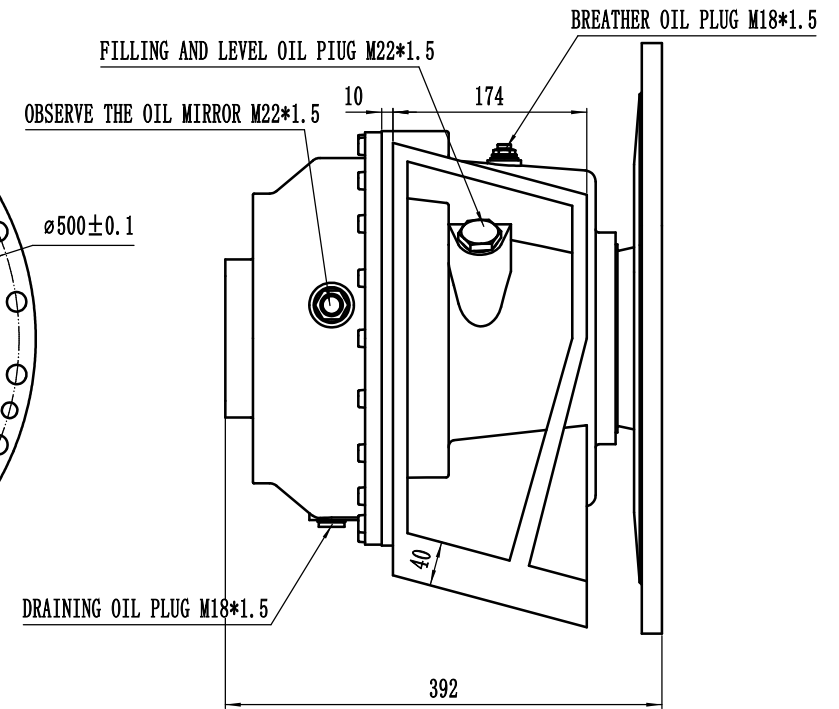
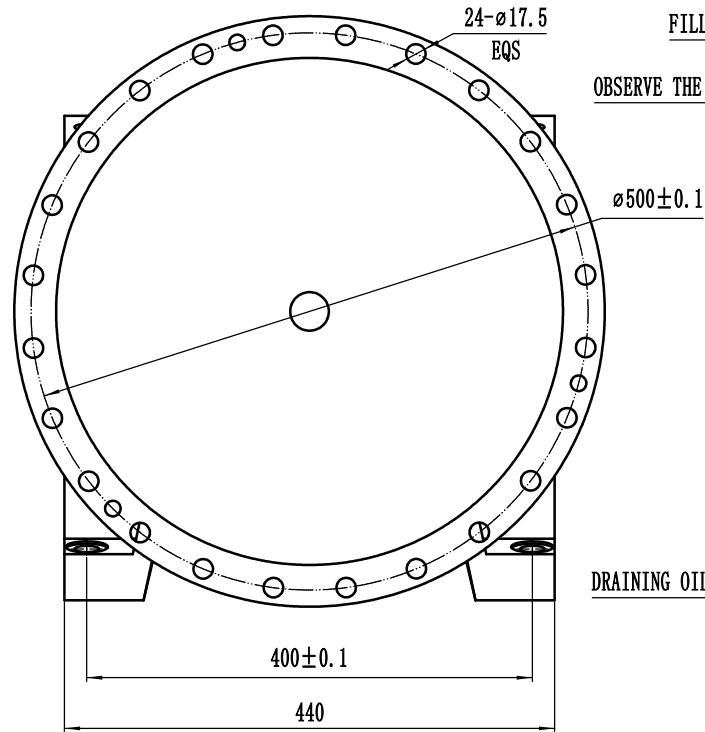
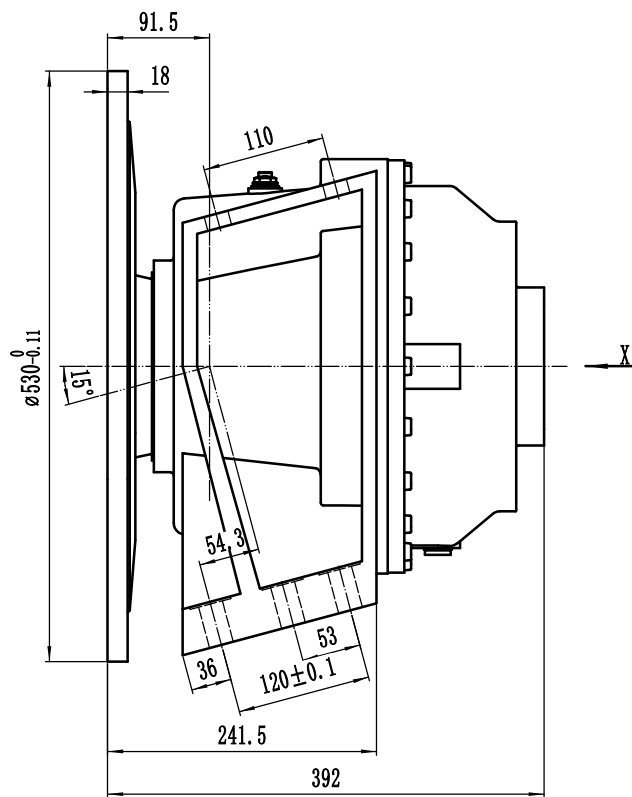

#### Gearbox Technical Data

Code number	MP3300
Drum Capacity	7 - 8 m <sup>3</sup>
Max. Output Torque	48000 Nm
Ratios (i)	1 : 133.7
Max. input Speed	2500 rpm
Use oil according to following normes: SAE 85W90/ API GL4 GL5	
Oil Quantity	7.5 lt ±10%
Dry Weight	190 kg
Hydraulic Motor	Provided by user

		Maxma Fluid Power Inc.	
Gearbox For Truck Mixer			
Code Number	MP3300	Ratio	1:3.5

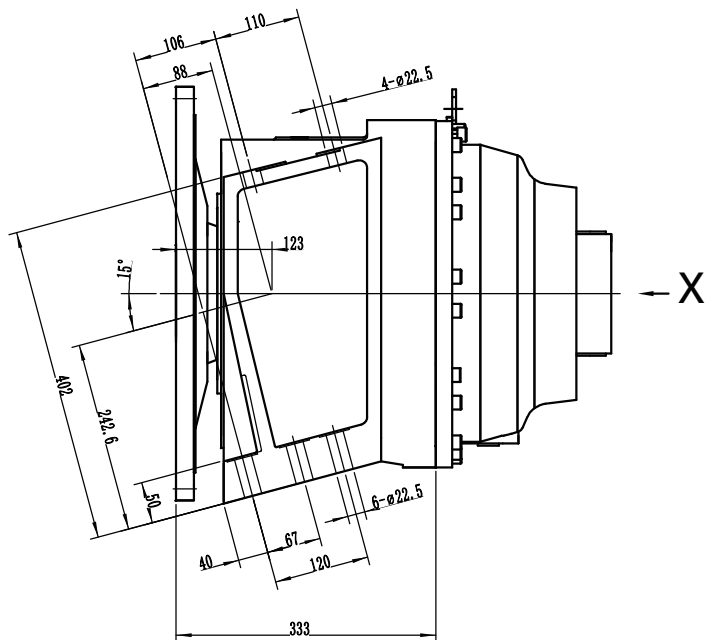

View X

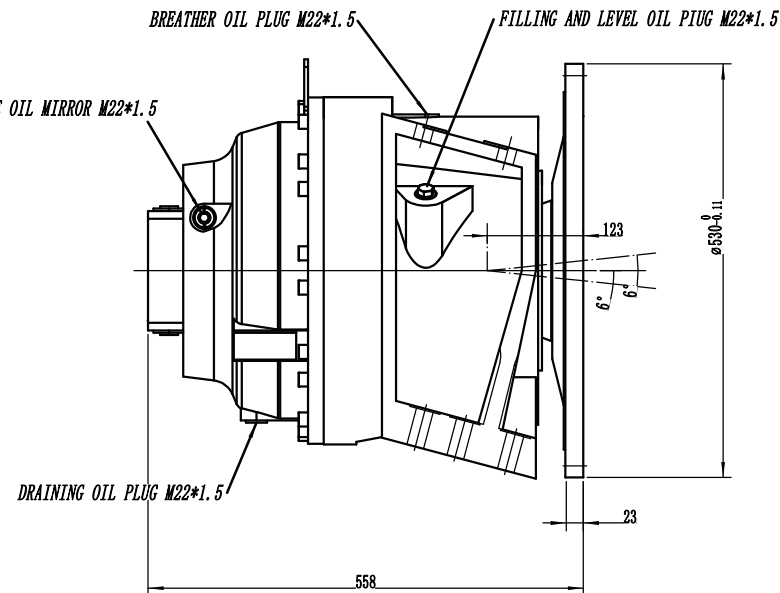
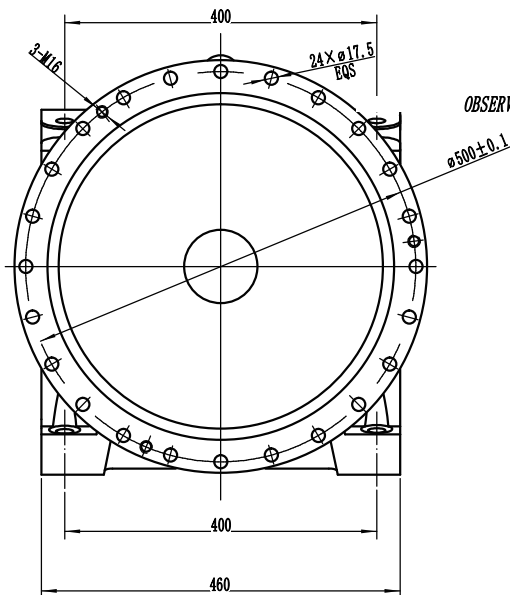
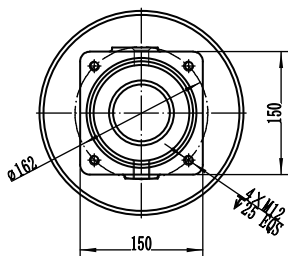

MOTOR ADAPTOR DETAIL

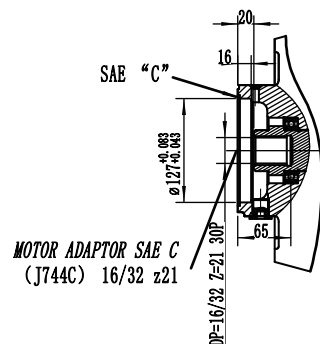

MOTOR ADAPTOR SAE C  
(J744C) 16/32 z21

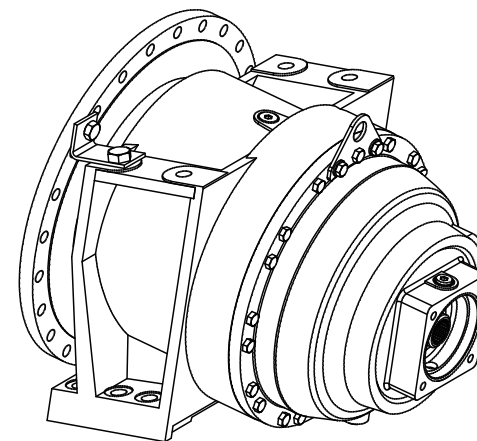

#### Gearbox Technical Data

Code number	MP4300
Drum Capacity	8 - 10 m <sup>3</sup>
Max. Output Torque	60000 Nm
Ratios (i)	1 : 135.3
Max. input Speed	2500 rpm
Use oil according to following normes: SAE 85W90/ API GL4 GL5	
Oil Quantity	14 ±10%
Dry Weight	330 kg
Hydraulic Motor	Provided by user

		Maxma Fluid Power Inc.	
Gearbox For Truck Mixer			
Code Number	MP4300	Ratio	1:5



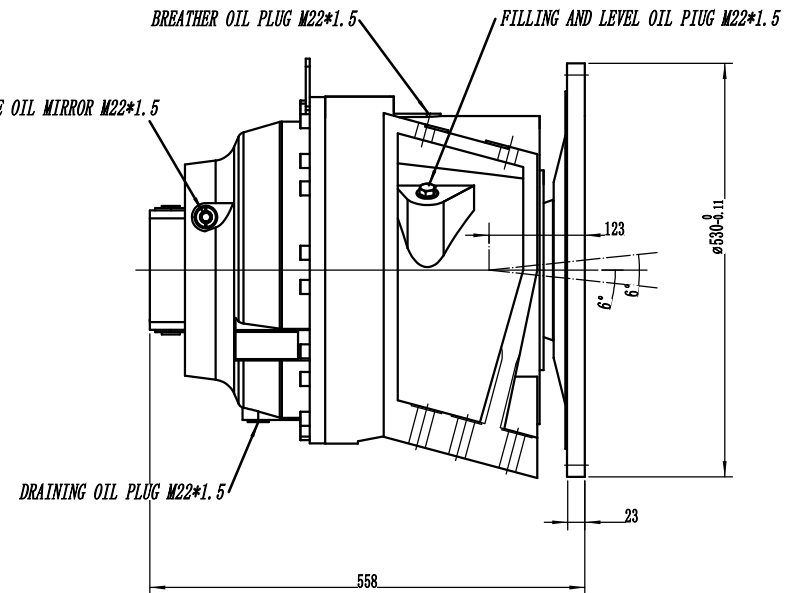
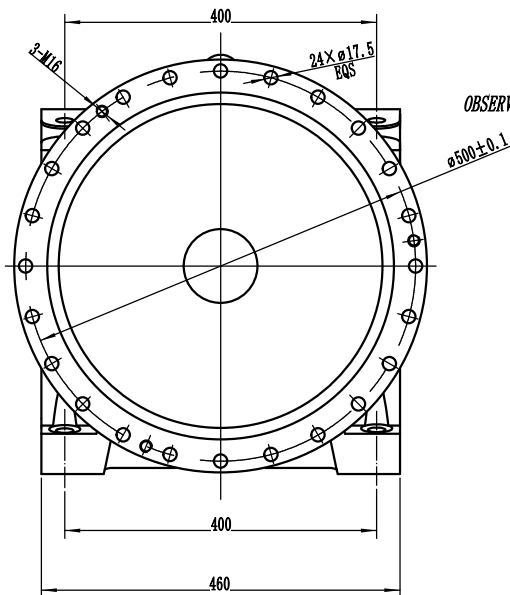
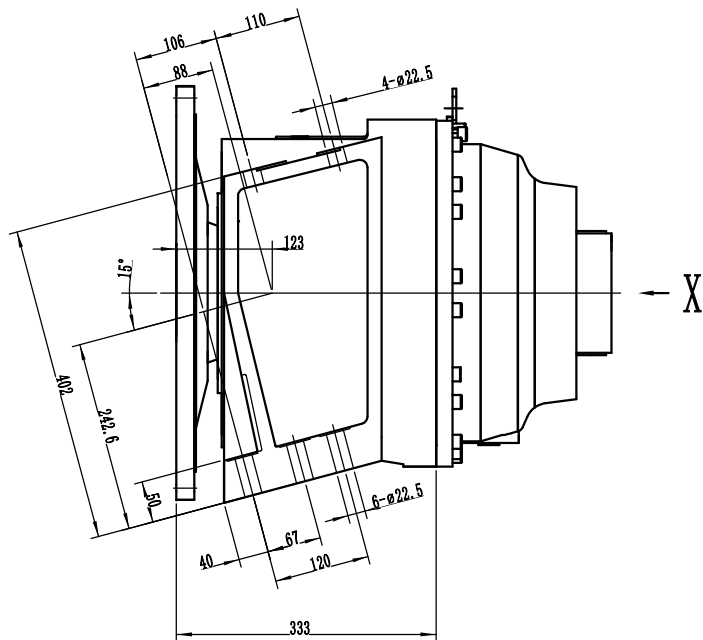

View X

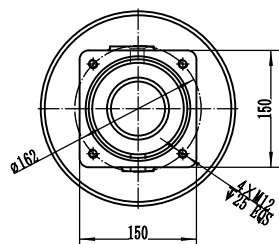

MOTOR ADAPTOR DETAIL

HYDRAULIC MOTOR AT NORMES SAE "C"

MOTOR ADAPTOR SAE C (J744C) 16/32 z21

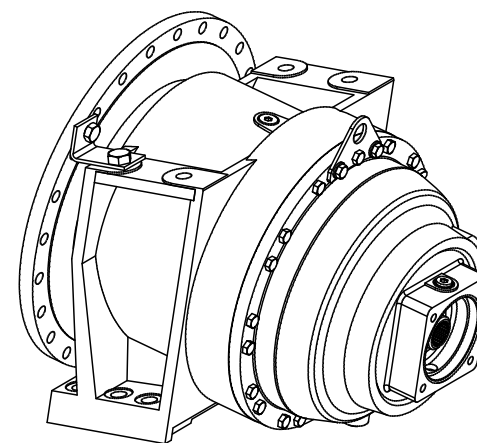
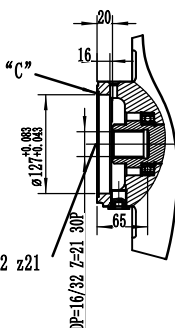

#### Gearbox Technical Data

Code number	MP5300
Drum Capacity	10 - 14 m <sup>3</sup>
Max. Output Torque	70000 Nm
Ratios (i)	1 : 135.3
Max. input Speed	2500 rpm
Use oil according to following normes: SAE 85W90/ API GL4 GL5	
Oil Quantity	14 ±10%
Dry Weight	335 kg
Hydraulic Motor	Provided by user

		Maxma Fluid Power Inc.	
Gearbox For Truck Mixer			
Code Number	MP5300	Ratio	1:5